

Fig 1

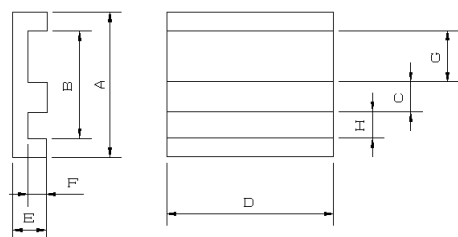

Fig.2

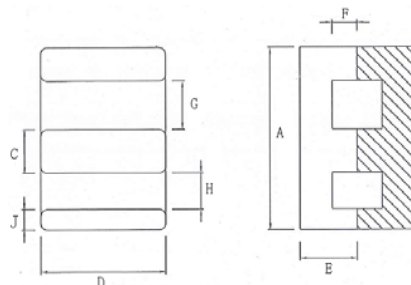

Fig.3

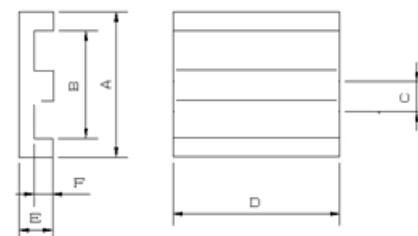

Fig.4

### EE型

尺寸Dim 型号 Type	图形 Fig.	A (mm)	B (mm)	C (mm)	D (mm)	E (mm)	F (mm)	G (mm)	H (mm)	C <sub>1</sub> (mm <sup>-1</sup> )	Le (mm)	Ae (mm <sup>2</sup> )	Ve (mm <sup>3</sup> )
EE4.2	1	4.35±0.1	3.95MIN	1.2±0.1	1.35±0.1	0.85±0.05	3.15±0.1	—	—	4.71	7.04	1.49	10.49
EE5	1	5.25±0.1	3.80MIN	1.35±0.1	1.95±0.1	2.0±0.075	2.65±0.075	—	—	5.01	12.68	2.53	32.08
EE6.3	1	6.3±0.25	3.6+0.2	1.32±0.08	2.0±0.15	1.92±0.08	—	—	—	3.64	12.13	3.33	40.39
EE8.3	1	8.3±0.3	6MIN	2.15±0.15	3.9±0.15	3.0MIN	4.4MAX	—	—	2.19	18.63	8.52	158.66
EE8.8	1	8.8±9.4	5.02-5.42	1.78-2.02	1.9-2.0	2.15MIN	4.0-4.2	—	—	3.02	15.64	5.17	80.94
EE9.3	1	9.3±0.15	6.3±0.15	2.0±0.1	2.3±0.15	2.9±0.15	4.4±0.15	—	—	3.4	19.51	5.73	111.80
EE10	1	10.3±0.2	7.7MIN	2.45±0.15	4.65±0.15	4.45±0.15	5.7±0.2	—	—	2.31	26.98	11.70	315.55
EE10A	1	10.2±0.3	7.5MIN	2.5±0.2	4.85±0.15	4.3±0.2	5.5±0.2	—	—	2.15	26.17	12.15	317.90
EE10B	1	10.2±0.3	7.5MIN	2.5±0.2	5.15±0.15	4.3±0.2	5.5±0.2	—	—	2.03	26.17	12.90	337.50
EE11/14	4	11.0±0.2	13.3±0.15	2.3±0.1	14.0±0.3	1.55±0.1	0.5±0.15	—	—	0.48	20.61	10.00	206.60
EE13	1	13.3±0.3	10.2±0.3	2.75±0.15	6.15±0.15	4.64±0.15	6.0±0.2	—	—	1.79	30.32	16.95	514.10
EE13B	1	13.3±0.3	9.2MIN	2.5±0.15	3.0±0.15	5.0±0.15	6.5±0.15	—	—	3.36	31.10	8.64	268.60
EE14.25/10.1	3	14.25±0.3	—	3.4±0.15	10.1±0.25	4.4±0.15	1.8±0.2	2.85±0.15	3.8±0.15	0.62	21.60	34.60	1015.70
EE18/9/8.28	1	18.00±0.2	13.3±0.15	4.70±0.15	9.00±0.2	1.5±0.15	4.14±0.15	—	—	0.49	22.38	45.02	1008.00
EE18/15.4	2	18±0.3	14±0.3	3.2±0.15	15.4±0.3	3.6±0.15	2.0±0.2	5.4±0.15	2.8±0.15	0.56	22.40	40.00	939.30
EE16	1	16.0±0.3	11.3MIN	4.0±0.2	4.7±0.2	5.2±0.2	7.3±0.2	—	—	1.81	35.23	19.49	686.55
EE16-L	1	16.0±0.3	11.3MIN	4.0±0.2	4.7±0.2	10.2±0.2	12.4±0.2	—	—	2.72	55.00	20.00	1116.00
EE16B	1	16.0±0.4	11.7MIN	4.0±0.2	4.9±0.2	5.35±0.2	7.3±0.3	—	—	1.81	35.23	19.49	686.55
EE16.5/7.0	1	16.5±0.3	10.5±0.2	3.18±0.15	7.0±0.15	4.85±0.2	7.25±0.15	—	—	1.11	31.91	28.77	918.00

型号 Type	尺寸Dim 图形 Fig.	A	B	C	D	E	F	G	H	C <sub>1</sub>	Le	Ae	Ve
		(mm)	(mm)	(mm)	(mm)	(mm)	(mm)	(mm)	(mm)	(mm <sup>-1</sup> )	(mm)	(mm <sup>2</sup> )	(mm <sup>3</sup> )
EE18	1	18.00±0.2	13.3±0.15	4.70±0.15	9.00±0.2	4.14±0.15	1.50±0.1	2.64±0.15	—	0.50	22.39	45.02	1008.00
EE18	2	18.00±0.3	11.4±0.3	3.2±0.15	15.4±0.3	3.4±0.15	1.40±0.1	5.4±0.15	2.8±0.15	0.32	19.90	62.28	1239.23
EE18/15.4	2	18±0.3	14±0.3	3.2±0.15	15.4±0.3	3.6±0.15	2.0±0.2	5.4±0.15	2.8±0.15	0.46	23.98	51.38	1231.1
EE19	1	19±0.3	14±0.3	5.0±0.15	8.0±0.15	5.0±0.15	7.5±0.15	—	—	0.92	36.85	40	1474.2
EE19	1	19±0.3	14.2MIN	5.0±0.2	4.55±0.15	5.7±0.2	8.15±0.3	—	—	1.67	40.00	23.00	954.00
EE19-L	1	20±0.3	14.3MIN	5.0±0.2	4.55±0.2	11.15±0.15	13.7±0.25	—	—	2.46	61.00	25.00	1553.00
EE20/23	1	20±0.4	14.2MIN	5.6±0.2	5.6±0.2	8.7±0.2	11.4±0.2	—	—	1.66	52.10	31.76	1603.90
EE21.6	1	21.60±0.35	16.6±0.35	4.8±0.15	4.8±0.2	8.4±0.15	10.7±0.15	—	—	2.29	52.81	23.05	1217.43
EE22	1	21.7±0.3	16.0±0.3	5.8±0.15	10.8±0.2	8.7±0.15	5.8±0.15	—	—	0.96147	36.921	38.4	1417.8
EE22-L	1	22.25±0.25	15.6MIN	5.7±0.25	5.7±0.25	11.2±0.25	15.26±0.25	—	—	1.79	65.10	36.30	2356.80
EE25	1	25.4±0.4	18.8MIN	6.35±0.3	6.3±0.25	6.6±0.35	9.7±0.3	—	—	1.21	48.00	40.00	1962.00
EE25-6	1	25.4±0.0.4	18.8MIN	6.35±0.3	6.6±0.25	12.75±0.25	15.9±0.25	—	—	1.84	73.61	40.05	2848.06
EE26	1	26.1±0.4	18.6+0.6	7.25±0.25	10.75±0.25	6.5±0.2	10.0±0.3	—	—	0.64	48.90	76.40	3735.86
EE27	1	26.8±0.3	19.6±0.3	7.3±0.2	11.1±0.2	7.35±0.175	11.05±0.15	—	—	0.66	53.20	81.00	4309.16
EE28	1	28.4±0.4	20MIN	7.2±0.3	10.0±0.2	9.7±0.2	14.2±0.2	—	—	0.82	64.60	79.20	5116.28
EE29	1	28.5±0.4	20.4MIN	7.15±0.2	11±0.2	6.75±0.2	11.0±0.2	—	—	0.62	52.90	85.40	4517.56
EE30	1	30.0±0.5	19.5MIN	6.95±0.25	7.05±0.25	10.0±0.3	15.0±0.2	—	—	1.10	65.60	59.70	3916.24
EE32	1	31.9±0.5	22.0MIN	8.9±0.25	12.7±0.3	9.65±0.25	14.0±0.3	—	—	0.58	66.20	114.30	7566.52
EE33	1	33.2±0.5	23.5MIN	9.7±0.3	12.7±0.3	9.65±0.25	14.0±0.3	—	—	0.57	67.00	117.10	7845.63
EE33.6/36.8	1	33.6±0.7	25MIN	9±0.3	36.8±0.3	27.05±0.3	31±0.3	—	—	0.43	137.07	317.29	43491.60
EE34	1	34.4±0.5	25.4MIN	9.2±0.3	9.2±0.3	9.95±0.25	13.9±0.3	—	—	0.89	69.40	78.00	5413.20
EE35	1	35.0±0.5	25MIN	10.3-0.5	12.0-0.25	9.1±0.15	15.1±0.2	—	—	0.55	68.30	124.00	8469.16
EE36	1	36±1.1	25.8MIN	10.1-0.7	10.1-0.7	13.0+0.7/-0.5	18.0±0.45	—	—	0.94	85.20	90.50	7710.48
EE40	1	40.0-0.5	27.5MIN	12.0-0.5	12.02-0.5	10.15±0.15	17.15±0.15	—	—	0.53	76.90	146.00	11227.26
EE41	1	41.3±0.5	28MIN	12.7±0.25	12.7±0.25	10.4±0.15	16.8±0.2	—	—	0.48	77.50	161.00	12477.36
EE42/15	1	42±0.7	29.5MIN	15.0±0.25	15.0±0.4	15.1±0.3	21.2±0.4	—	—	0.52	97.50	183.44	17802.85
EE42/20	1	42±0.7	29.5MIN	12.0±0.25	20.4±0.4	15.1±0.3	21.2±0.4	—	—	0.40	97.26	240.71	23410.70
EE42/20(大内档)	1	42±0.7	30.6MIN	12.0±0.25	20.4±0.4	15.1±0.3	21.2±0.4	—	—	0.40	97.26	240.71	23410.70
EE42/20(大内径)	1	42.5+0.9/-0.7	30.6MIN	12.0±0.3	19.5±0.4	15.4+0.4/-0.2	21.2±0.3	—	—	0.43	98.94	230.53	22807.52
EE42B/15	1	42±0.7	29.5MIN	12.0±0.25	15.0±0.4	18.5±0.3	24.3±0.4	—	—	0.42	110.38	179.55	19818.68

尺寸Dim 型号 Type	图形 Fig.	A (mm)	B (mm)	C (mm)	D (mm)	E (mm)	F (mm)	G (mm)	H (mm)	C <sub>1</sub> (mm <sup>-1</sup> )	Le (mm)	Ae (mm <sup>2</sup> )	Ve (mm <sup>3</sup> )
EE42B/20	1	42±0.7	29.5MIN	12.0±0.25	20.0±0.4	18.5±0.3	24.3±0.4	—	—	0.40	110.38	239.40	26424.86
EE49	1	48.8±0.7	31.8MIN	15.6±0.25	15.6±0.3	12.1±0.2	20.6±0.3	—	—	0.36	91.00	254.30	23141.30
EE50	1	50.0±0.7	34.6±0.4	14.6±0.4	14.6±0.4	12.75±0.25	21.3±0.3	—	—	0.42	95.90	228.00	21865.20
EE51	1	50.6±0.5	35.8min	15.0±0.3	23.80±0.3	15.5±0.2	8.4±0.3	—	—	0.2223	77.224	347.38	26826.1
EE52	1	52.45±0.8	32.2+1.2	19.75±0.3	6.35±0.3	31.25±0.3	41.75±0.3	—	—	0.98	151.00	154.00	23254.00
EE55	1	55.15±1.05	38.1±0.6	16.95±0.25	20.7±0.3	18.8±0.3	27.5±0.3	—	—	0.35	123.00	355.00	43665.00
EE56	1	56.0±0.7	37.5MIN	17.2±0.2	25.0±0.25	19±0.2	28±0.25	—	—	0.28	125.00	441.00	15125.00
EE62	1	62.3±1.0	36.0MIN	25.3±0.5	6.1±0.2	18.7±0.25	31±0.25	—	—	0.812	125.00	154.00	19250.02
EE63	1	63±1.0	37.6MIN	25.3±0.5	6.1±0.2	18.7±0.25	31±0.25	—	—	0.84	127.00	151.00	19177.04
EE65	1	65.15±1.35	44.95±0.75	19.65±0.35	27.1±0.3	22.55±0.35	32.5±0.3	—	—	0.28	147.00	532.00	78204.10
EE66	1	66±1.0	46.0min	20+0/-0.7	27.5+0/-0.5	32.8+0/-0.5	22.2+0.5/-0	—	—	0.271	147.57	543.03	80133.90
EE70	1	70.5±1.0	48.0+1.5	21.65±0.35	31.6±0.4	22.25±0.35	32.95±0.25	—	—	0.22	150.00	686.00	12900.02
EE70B	1	70.0±1.0	48.0MIN	21.65±0.35	31.6±0.4	22.5+0.5	33.5±0.3	—	—	0.22	151.37	686.63	103933.80
EE70C	1	70+1.3/-0.8	47.2MIN	22.4+0/-0.7	32+0/-0.8	43±0.4	54.0±0.25	—	—	0.327	232.04	708.76	164457.10
EE71		70+2/-0.5	48.7min	22+0.1/-0.7	32-0.8	33±0.3	22.4±0.3	—	—	0.219	150.40	684.76	102989.30
EE72	1	72.45±0.8	42.2+1.5	29.75±0.3	6.35±0.3	42.6±0.3	58.6±0.3	—	—	0.807	185.00	230.00	42550.00
EE85/31.5/91	1	85+2/-2.5	55.0min	26.6+0.6/-0.3	31.5±0.5	45.5±0.5	31+1.5/-0	—	—	0.2256	198.64	880.49	174899.70